



WE CARE

Solutions for handling control

+39 039 99.11.011



Home



PFA9165A0103006

Home Page | Print



IP 65 CE EAC

Ratio 1:103,57

Cable clamp PRPS0062PE

Notes

Shaft

Code ALL1R00001
 End side Front
 Length (L) 35,00 mm
 Flexible No
 End type Radial hole
 Dimension A 4,00 mm
 Dimension B 7,00 mm
 mm
 mm

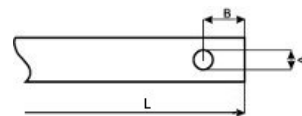

Pinion (fitted with adaptor PRTO1075PE) PRSL0919PI

Cam Set Code: PRFC0008PEC

	Cams	Switches
2	PRSL7140PI	PRSL0003XX
1	PRSL7140PI	PRSL0003XX

Note: cams numbering is bottom up

- Anti condensation option
- Serial numbering
- SIL 1
- No-drop wire

This configuration has been saved in our records and will be valid 180 days from the date of creation. After that date it will be deleted. The image is representative and does not match the actual product.

For more information on this product or to get a quote contact us