

**FPZ**  
BLOWER TECHNOLOGY

LISTA PEZZI SOFFIANTI  
BLOWER PART LIST

16/01/2014

**K12-MS MOR**

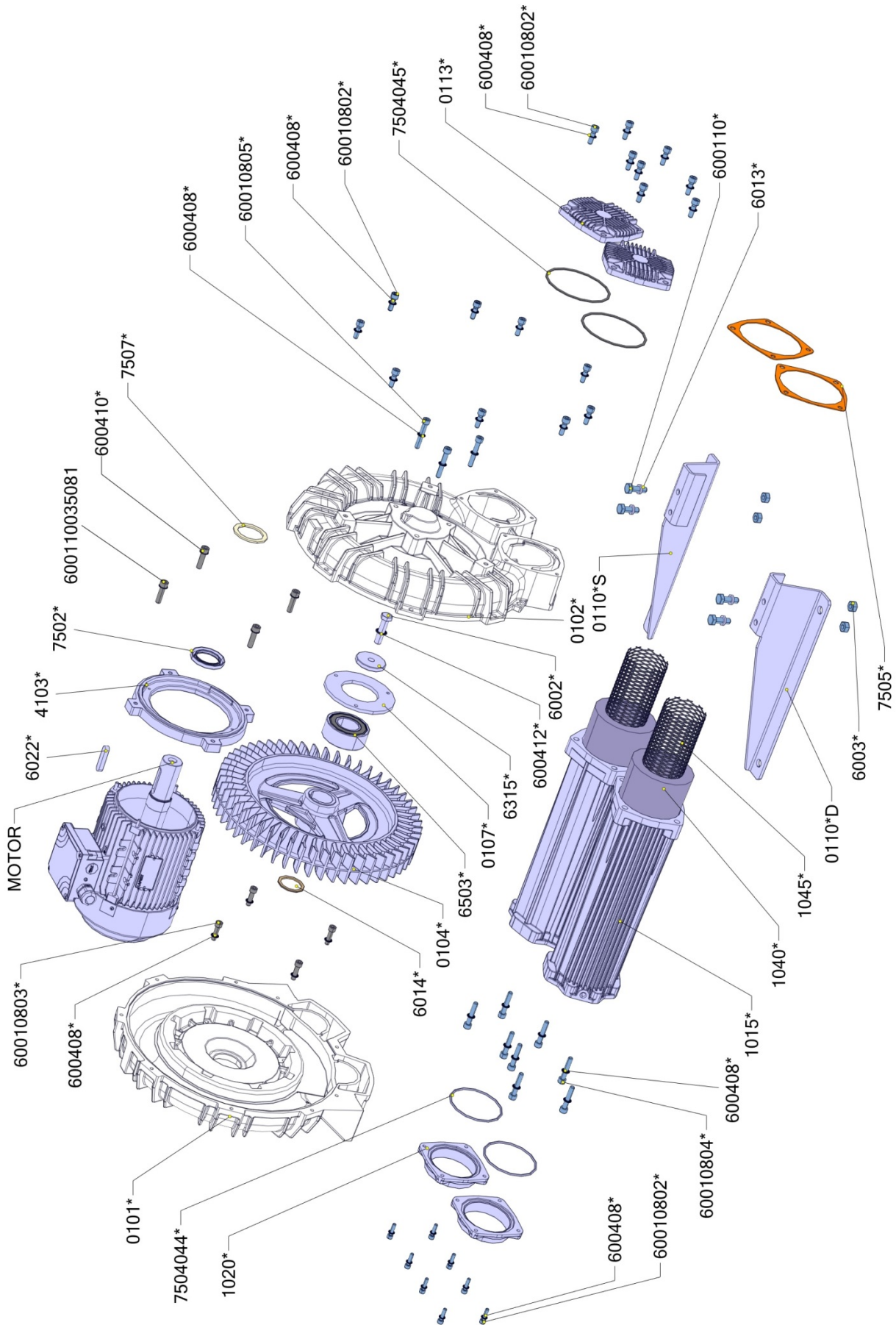

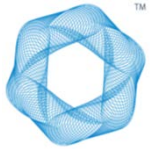

**FPZ**  
BLOWER TECHNOLOGY

LISTA PEZZI SOFFIANTI  
BLOWER PART LIST

16/01/2014

**K12-MS MOR**

CODICE Code	Descrizione Description	Quantità Quantity		MATERIALE Type/Material
		GR.132	GR.160	
4051+ADJN	MOTORE ELETTRICO ELECTRIC MOTOR	X	-	9.2KW 400/690-50 VHZ
4051+ADJN		X	-	11KW 400/690-50 VHZ
4051+0018		X	-	15KW 400/690-50 VHZ
4053+0002		-	X	18.5KW 400/690-50 VHZ
0107K0700100	COPERCHIO CUSCINETTO BEARING COVER	1	1	
0110K0700102	PIEDE FE P01 ZINCATO SINISTRO FOOT FE P01 ZINC. LEFT	1	1	
0110K0701102	PIEDE FE P01 ZINCATO DESTRO FOOT FE P01 ZINC. RIGHT	1	1	
602508025100	ANTIVIBRANTE MF M8X15 D.30X25 SILENT BLOCK MF M8X15 D.30X25	4	4	
631580100050	RONDELLA BLOCCAGGIO GIRANTE ZINCATA WASHER TO BLOCK ZINC.	1	1	
650323208000	CUSCINETTO 3208A 2Z TN9 C3 BEARING 3208A 2Z TN9 C3	1	1	
0101K1200001	CORPO K12 MS/TS/TD HOUSING K12 MS/TS/TD	1	1	AL AC-45000SF
0102K1200001	COPERCHIO K12 MS/TS/TD COVER K12 MS/TS/TD	1	1	
0104K1102001	GIRANTE K11/K12 MS IMPELLER K11/K12 MS	1	1	AC AL-45000SF
0113K0910004	FLANGIA CIECA PRESSOFUSA 4" BLIND FLANGE 4"	2	2	
1015K0920004	FUSTO SILENZIATORE 4" PRESSOFUSO SILENCER 4"	2	2	
102090300004	FLANGIA GAS 4" PRESSOFUSA FLANGE GAS 4"	2	2	
1040K0900700	PANNO FONOASSORBENTE 4" SOUND INSULATING PANEL 4"	2	2	
104590100101	RETINO SOSTEGNO SUPPORTING SCREEN	2	2	
750404462851	ANELLO OR 4462 O-RING 4462	2	2	
750404512851	ANELLO OR 4512 O-RING 4512	2	2	
7505K0900880	GUARNIZIONE PIANA BETAFLEX 72 GASKET BETAFLEX 72	2	2	
410316201001	ADATTATORE MOTORE GR.160 X SCL K09/K11-MS/MD MOTOR ADAPTER GR.160 X SCL K09/K11-MS/MD	-	1	
602212055050	CHIAVETTA C40 12 X 8 X 55 KEY C40 12 X 8 X 55	1	1	
750250657855	ANELLO TENUTA MIM VITON 50 X 65 X 8 AS SEAL RING MIM VITON 50 X 65 X 8 AS	1	1	
750750100876	ANELLO FELTRO FELT RING	1	1	



LISTA PEZZI SOFFIANTI  
BLOWER PART LIST

16/01/2014

K12-MS MOR

CODICE Code	Descrizione Description	Quantità Quantity		MATERIALE Type/Material
		GR.132	GR.160	
600412000066	RONDELLA ZIGRINATA SCHNORR S12 C60 ZINC. DIN 9250 WASHER SCHNORR S12 C60 ZINC. DIN 9250	1	1	CL.8.8 ACC.ALTA RESISTENZA
600212035081	VITE TE M12 X 35 UNI 5739 ACC. CL 8.8 ZN SCREW TE M12 X 35 UNI 5739 ACC. CL 8.8 ZN	1	1	CL.8.8 ACC.ALTA RESISTENZA
600108030081	VITE TCEI M8 X 30 UNI 5931 ACC. CL 8.8 ZN SCREW TCEI M8 X 30 UNI 5931 ACC. CL 8.8 ZN	4	4	CL.8.8 ACC.ALTA RESISTENZA
600108025081	VITE TCEI M8 X 25 UNI 5931 ACC. CL 8.8 ZN SCREW TCEI M8 X 25 UNI 5931 ACC. CL 8.8 ZN	25	25	CL.8.8 ACC.ALTA RESISTENZA
600408000066	RONDELLA ZIGRINATA SCHNORR S8 C60 ZINC. DIN 9250 WASHER SCHNORR S8 C60 ZINC. DIN 9250	40	40	CL.8.8 ACC.ALTA RESISTENZA
600108045081	VITE TCEI M8 X 45 UNI 5931 ACC. CL 8.8 ZN SCREW TCEI M8 X 45 UNI 5931 ACC. CL 8.8 ZN	8	8	CL.8.8 ACC.ALTA RESISTENZA
600310200090	DADO ESAGONALE M10 UNI 5588 - ISO 4032 HEXAGONAL NUT M10 UNI 5588 - ISO 4032	4	4	CL.10 ACC.ALTA RESISTENZA
604440501079	RONDELLA DI AGGIUSTAGGIO SEEGER PS 40X50X0.1 SHIM WASHER SEEGER PS 40X50X0.1	1	1	ACC. ST2 K 60
600108050081	VITE TCEI M8 X 50 UNI 5931 ACC. CL 8.8 ZN SCREW TCEI M8 X 50 UNI 5931 ACC. CL 8.8 ZN	3	3	
600110030081	VITE TCEI M10 X 30 UNI 5931 ACC. CL 8.8 ZN SCREW TCEI M10 X 30 UNI 5931 ACC. CL 8.8 ZN	4	4	CL.8.8 ACC.ALTA RES.
601310100075	ROSETTA ELASTICA 10.5X17.5X2.2 UNI 1751 DIN127-B ELASTIC WASHER 10.5X17.5X2.2 UNI 1751 DIN127-B	4	4	A2-70 ACC.INOX
600110035081	VITE TCEI M10 X 35 UNI 5931 ACC. CL 8.8 ZN SCREW TCEI M10 X 35 UNI 5931 ACC. CL 8.8 ZN	-	4	
600410000066	RONDELLA ZIGRINATA SCHNORR S10 C60 ZINC. DIN 9250 WASHER SCHNORR S10 C60 ZINC. DIN 9250	-	4	